

VERSIONS	
A	INITIAL

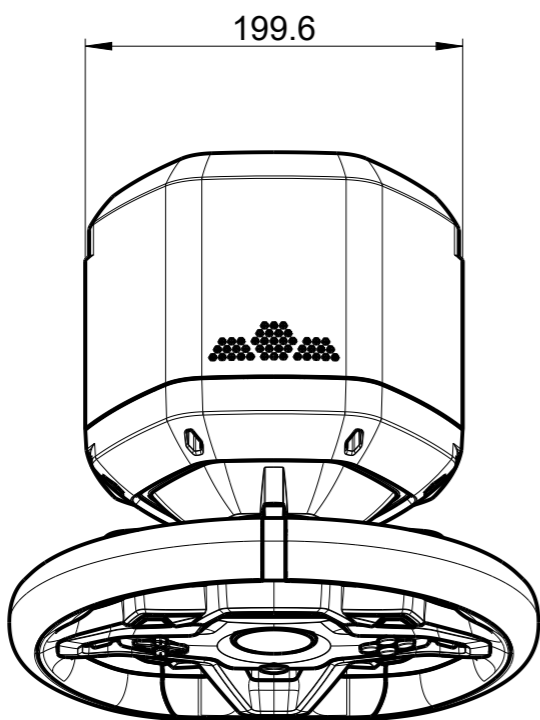

COCKPIT FIXATION

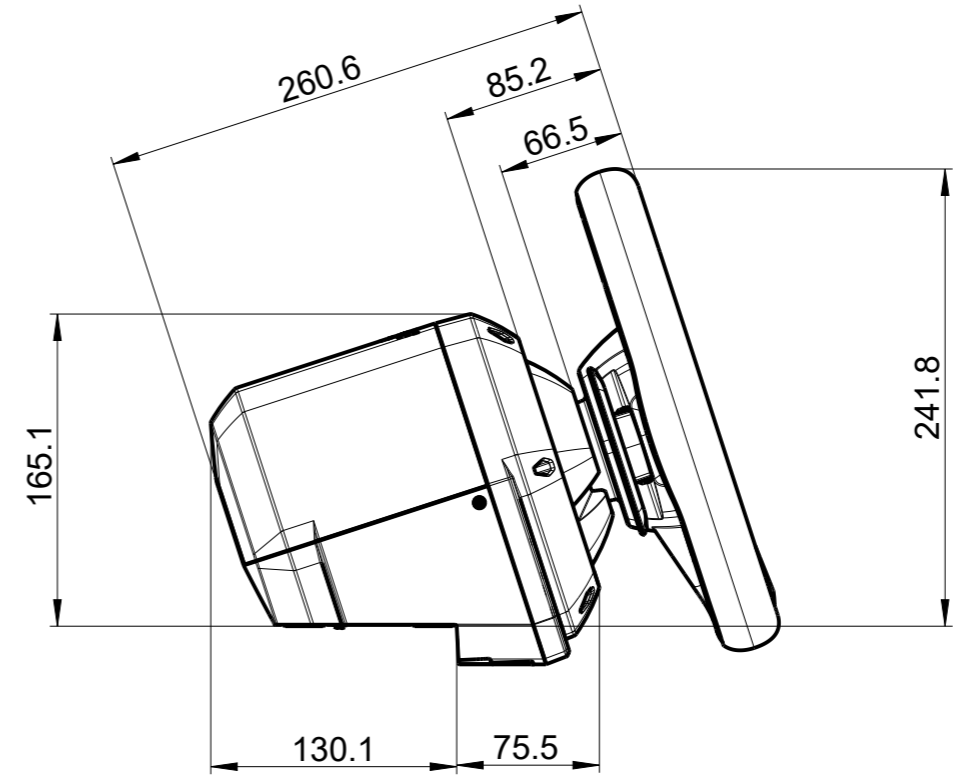
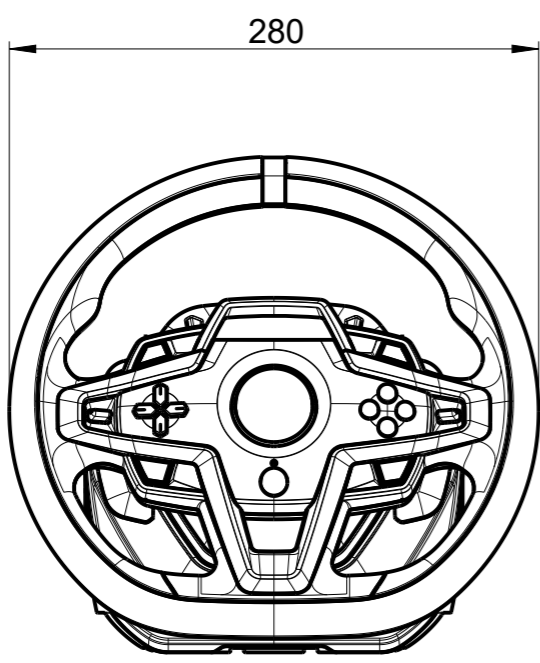
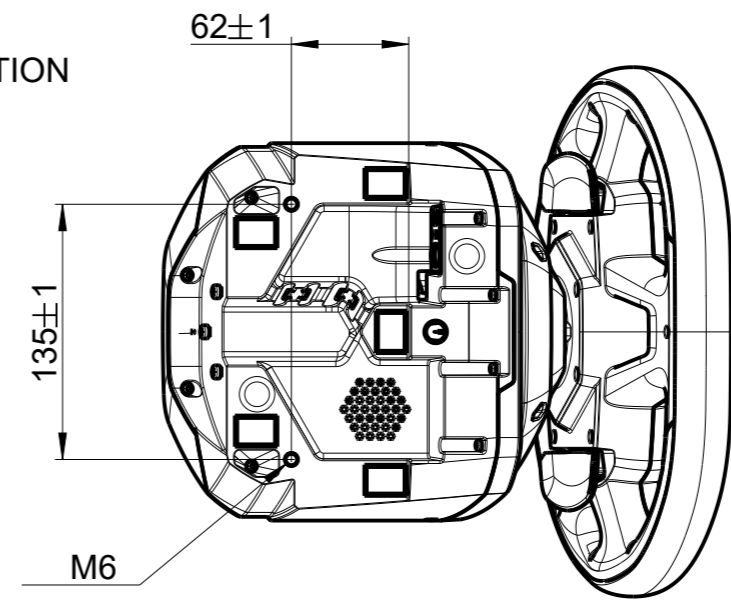

MATERIAL n/a	DRAWN BY THRUSTMASTER	DATE 2021-07-07	GUILLEMOT CORPORATION HERCULES THRUSTMASTER		
DIMENSIONAL TOLERANCES UNLESS OTHERWISE SPECIFIED MILLIMETERS X>100mm : ±0.3mm 30<X<100mm : ±0.2mm X<30mm : ±0.1mm	CHECKED BY	DATE			NAME
	APPROVALS			DWG NO. T248-OUTER-DIM	SIZE A3
MASSE n/a			SCALE 1/4		
FIRST ANGLE PROJECTION 		PLAN			

VERSIONS

A INITIAL

SCALE 1/1
(PRINT ON A3 FORMAT)

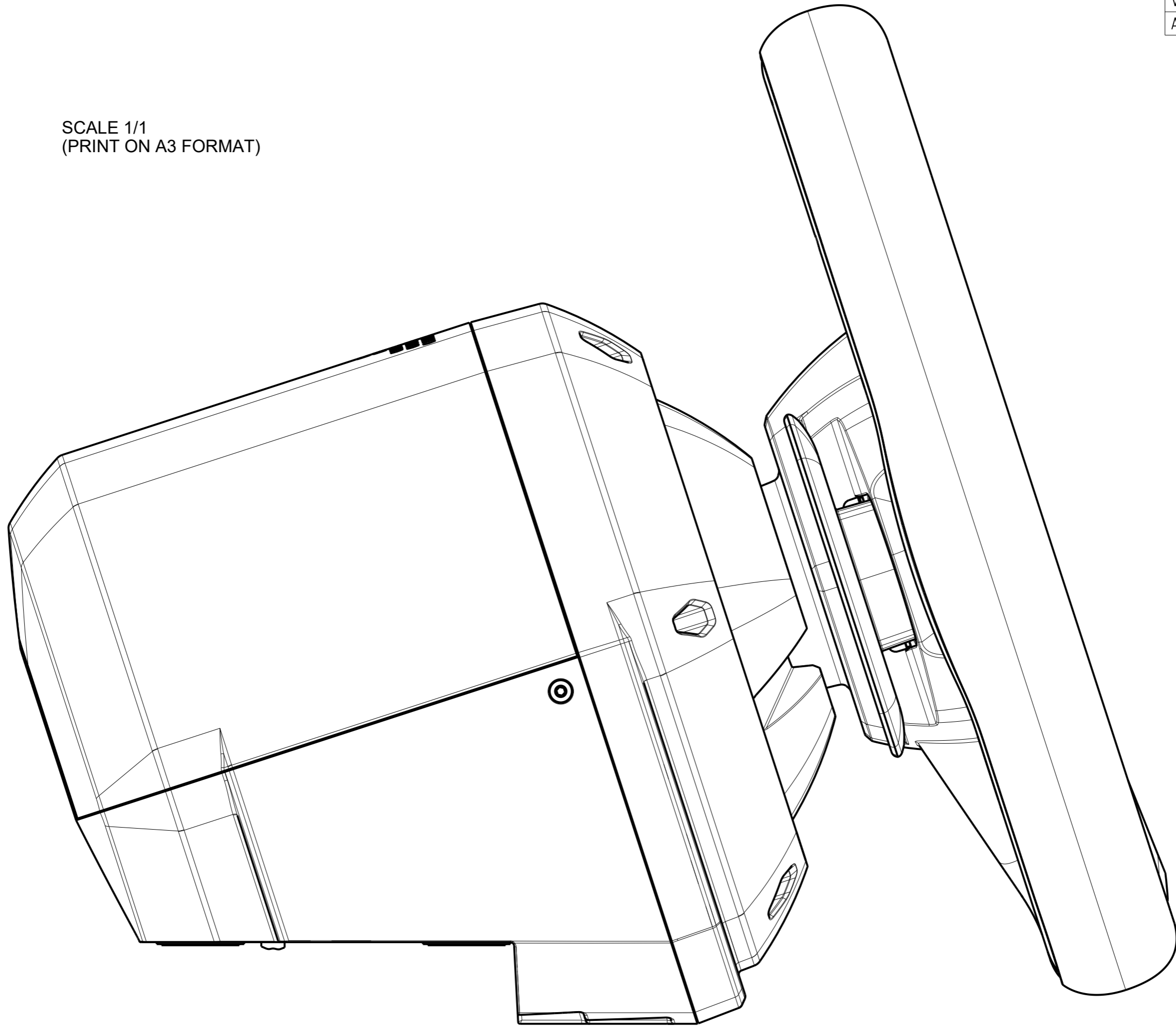

VERSIONS	
A	INITIAL

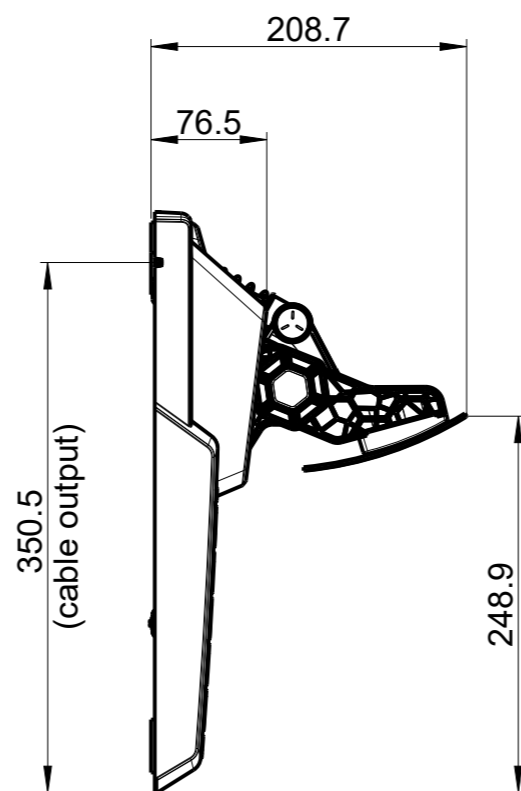
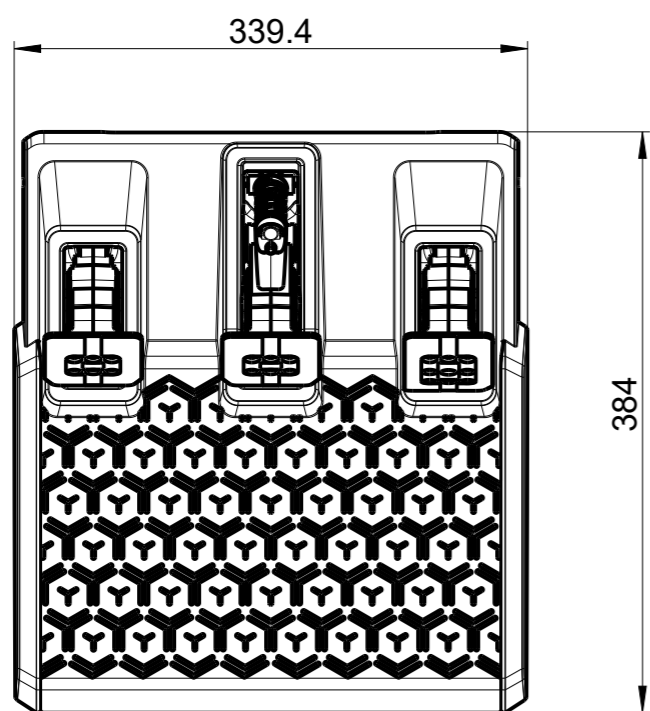
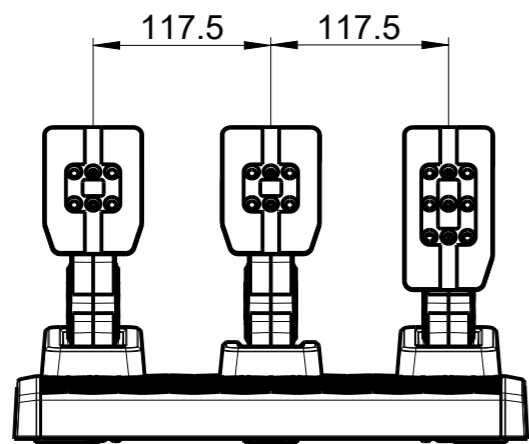

Cockpit fixation nuts
 !! Recommendation : screw heads should be directly connected to power ground !!

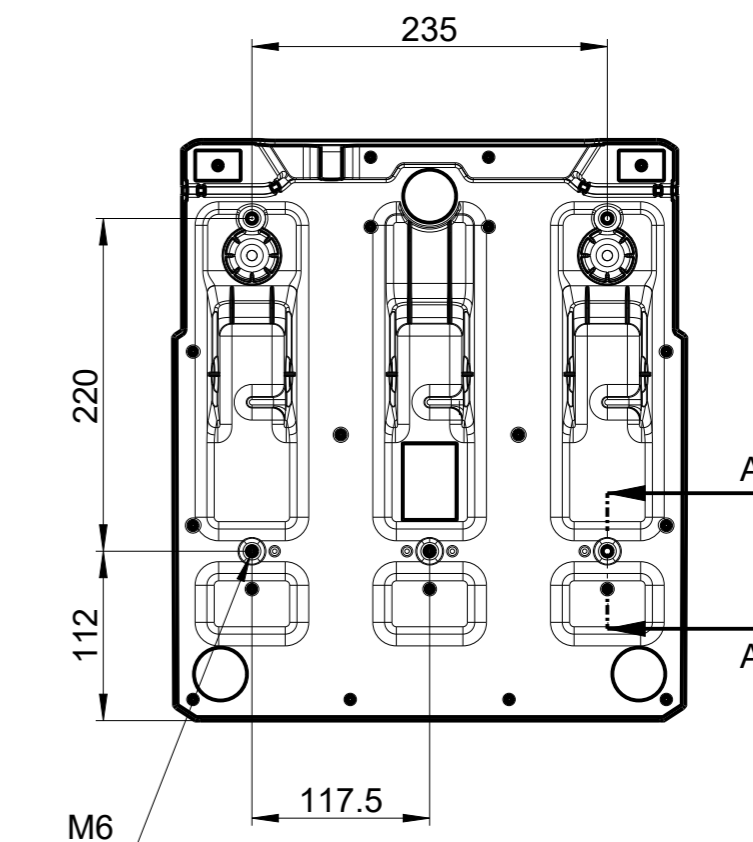

DIMENSION OF M6 FIXATION SCREW

SECTION A-A
 SCALE 1/1

MOUNTING SCREW
 LENGTH INSIDE BODY

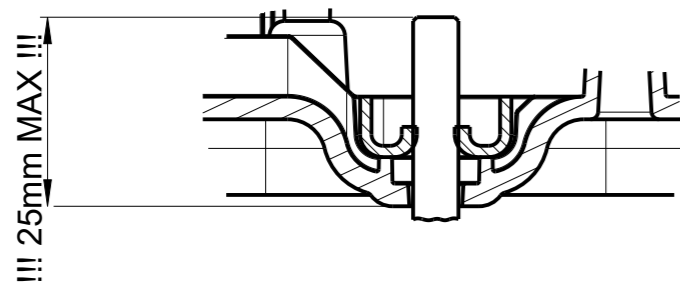

MATERIAL n/a	DRAWN BY THRUSTMASTER	DATE 2021-07-07	GUILLEMOT CORPORATION HERCULES THRUSTMASTER	
DIMENSIONAL TOLERANCES UNLESS OTHERWISE SPECIFIED MILLIMETERS X>100mm : ±0.3mm 30<X<100mm : ±0.2mm X<30mm : ±0.1mm	CHECKED BY	DATE		
FIRST ANGLE PROJECTION 	APPROVALS		DWG NO.	
	MASSE n/a	PLAN		T3PM-OUTER-DIM
	SCALE 1/5		SHEET 1 OF 2	
			SIZE A3	

VERSIONS

A INITIAL

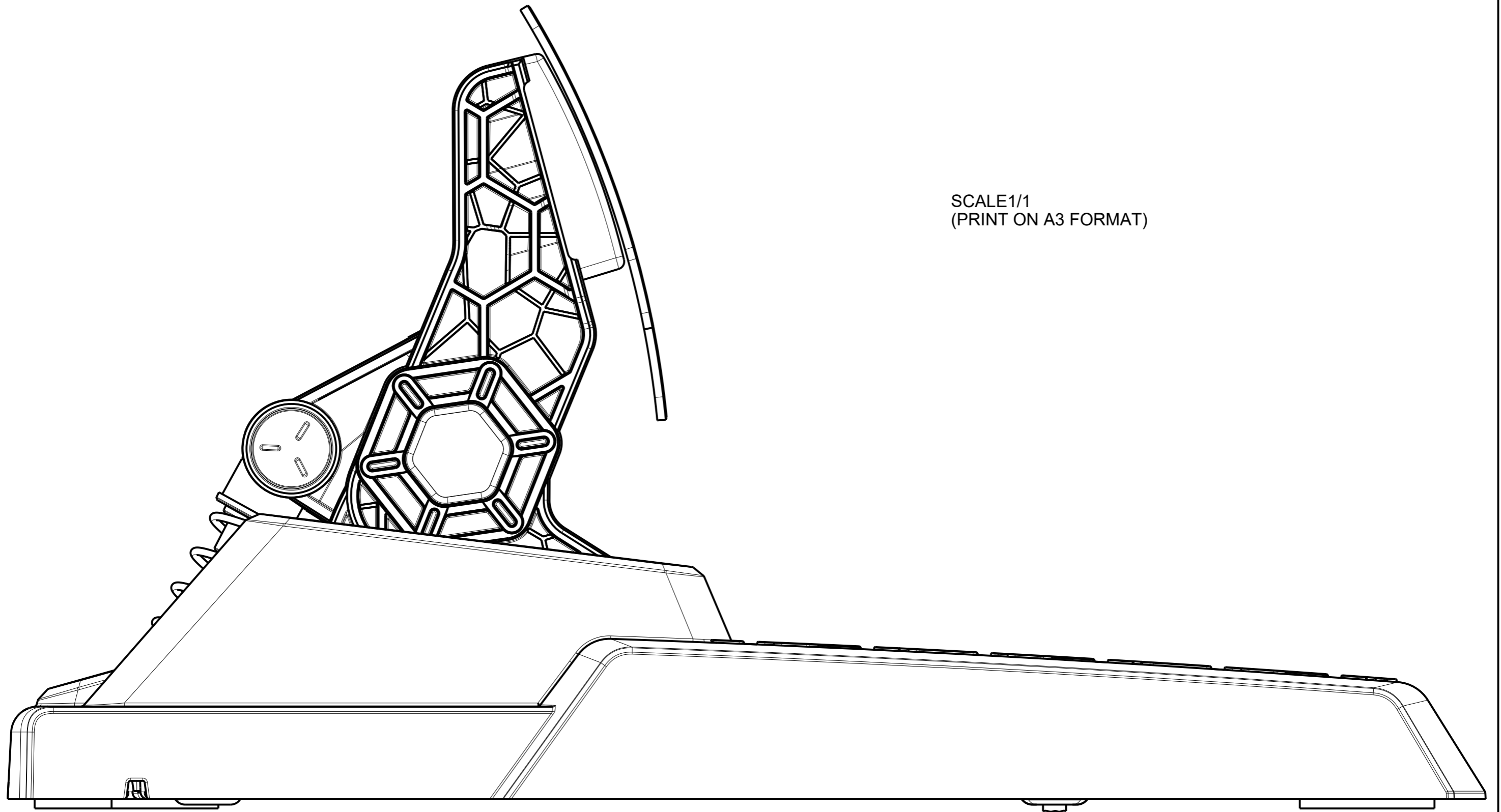

SCALE 1/1
(PRINT ON A3 FORMAT)